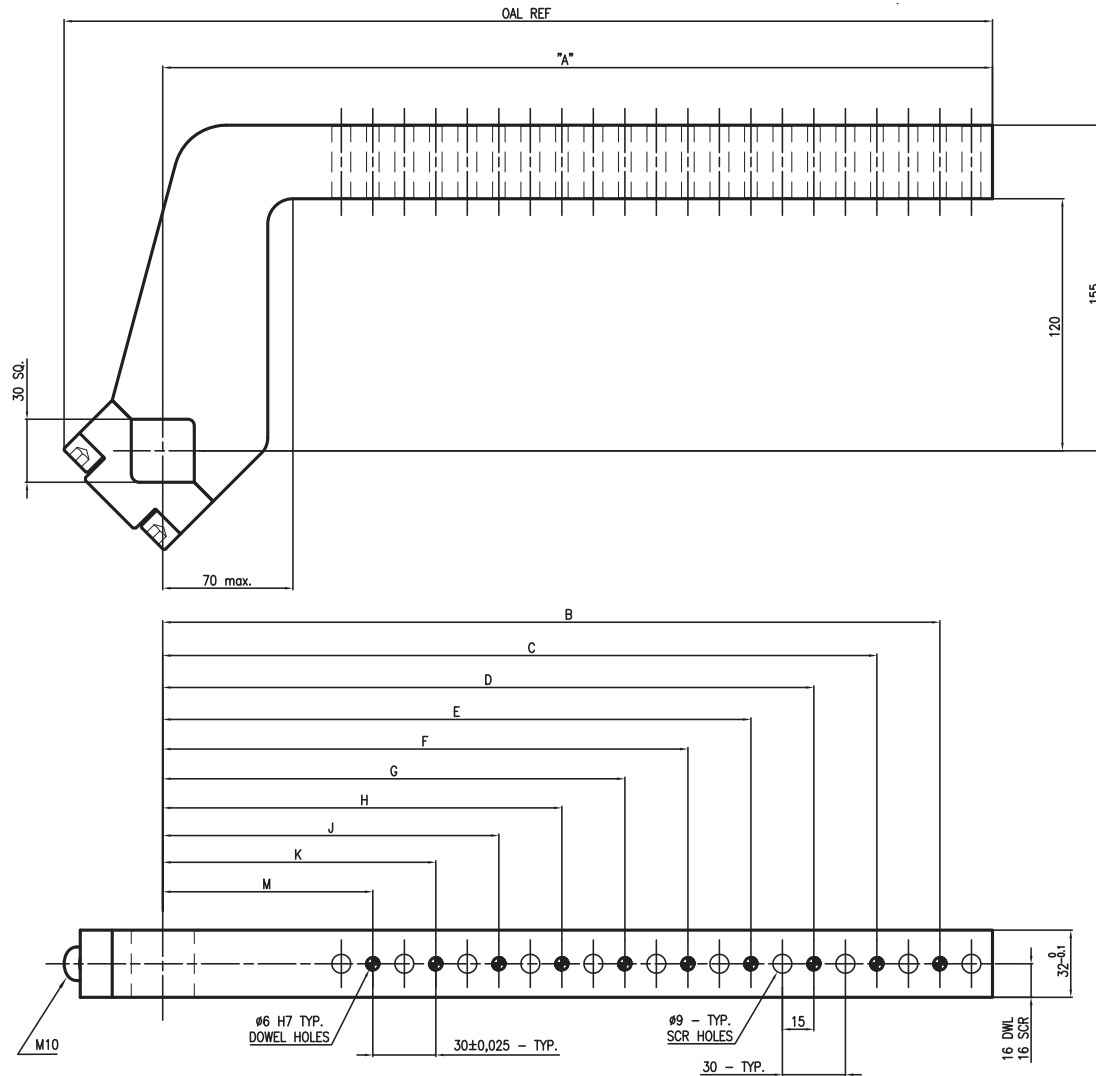

LKPGCA170M - LKPGCA171M - LKPGCA172M - LKPGCA173M

□ 30 mm, offset 120 mm

LKPGCA174M - LKPGCA175M - LKPGCA176M - LKPGCA177M - LKPGCA178M

Code	N.A.A.M.S Code	A	B dowel	C	D dowel	E	F dowel	G	H dowel	J	K dowel	M	Weight Kg	OAL REF	Material
LKPGCA170M	GCA0170M	155	130	100									3,51	202	Steel
LKPGCA171M	GCA171M	185	160	130	100								3,74	232	Steel
LKPGCA172M	GCA172M	215	190	160	130	100							3,98	262	Steel
LKPGCA173M	GCA173M	245	220	190	160	130	100						4,22	292	Steel
LKPGCA174M	GCA174M	275	250	220	190	160	130	100					4,46	322	Steel
LKPGCA175M	GCA175M	305	280	250	220	190	160	130	100				4,70	362	Steel
LKPGCA176M	GCA176M	335	310	280	250	220	190	160	130	100			4,93	382	Steel
LKPGCA177M	GCA177M	365	340	310	280	250	220	190	160	130	100		5,17	412	Steel
LKPGCA178M	GCA178M	395	370	340	310	280	250	220	190	160	130	100	5,41	442	Steel