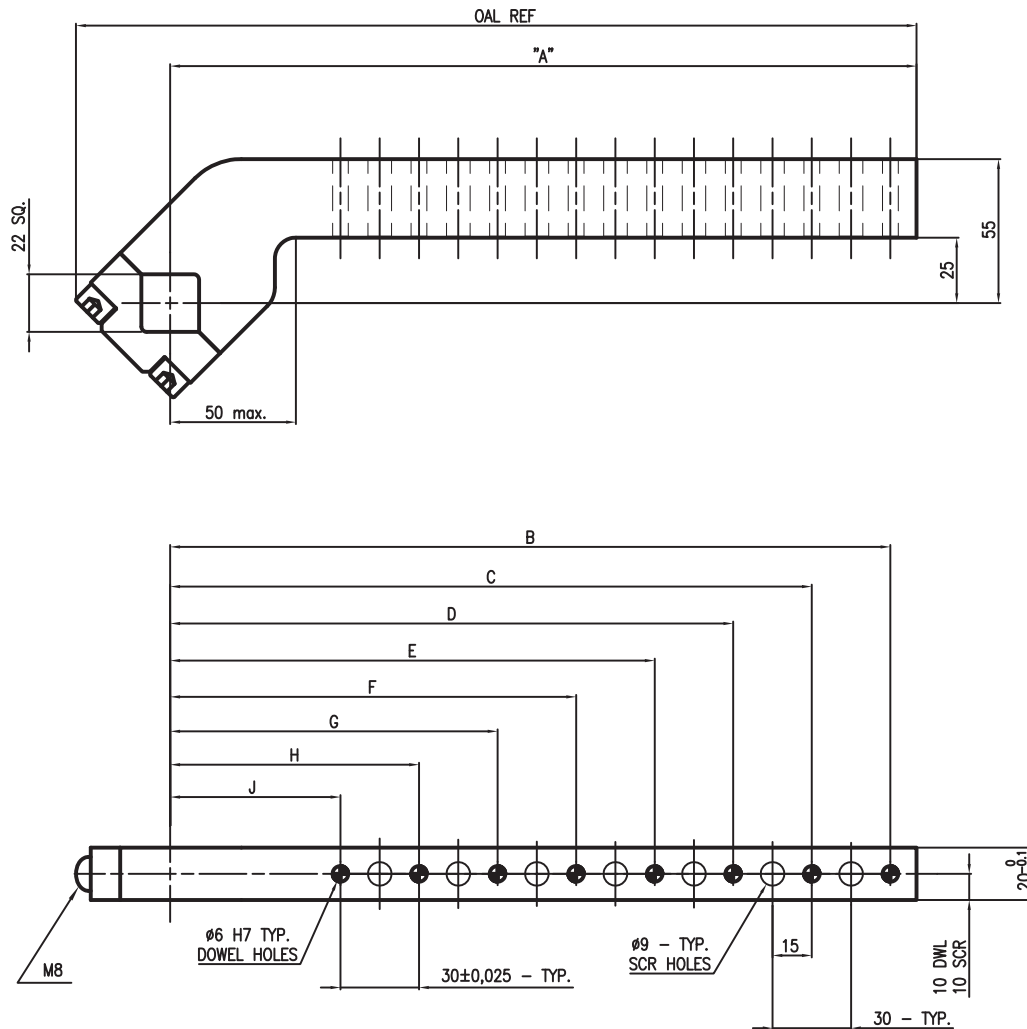

**LKPGCA019M / LKPGCA020M/ LKPGCA021M**

□ 22 mm, offset 25 mm

**LKPGCA022M - LKPGCA023M - LKPGCA024M**

Code	N.A.A.M.S Code	A	B dowel	C	D dowel	E	F dowel	G	H dowel	J	Weight Kg	OAL REF	Material
LKPGCA019M	GCA019M	135	125	95	65						0,94	171	Steel
LKPGCA020M	GCA020M	165	155	125	95	65					1,06	201	Steel
LKPGCA021M	GCA021M	195	185	155	125	95	65				1,18	231	Steel
LKPGCA022M	GCA022M	225	215	185	155	125	95	65			1,30	261	Steel
LKPGCA023M	GCA023M	255	245	215	185	155	125	95	65		1,42	291	Steel
LKPGCA024M	GCA024M	285	275	245	215	185	155	125	95	65	1,54	321	Steel