

# HGO

## Raccordi ad ogiva

I raccordi ad ogiva vengono così definiti in quanto il serraggio del tubo sul raccordo avviene mediante la compressione di un'ogiva tagliente che va ad aggrapparsi al tubo stesso.

I raccordi ad ogiva sono adatti negli assemblaggi di tubi rigidi (rame, ottone...); per eventuali utilizzi di tubi "plastici" è necessario utilizzare un apposito rinforzo (cod. HGO32) che va inserito all'interno del tubo fino all'apposita battuta d'appoggio.



### CARATTERISTICHE TECNICHE

Temperatura	-15 ÷ 80 °C
Fluido	aria compressa, acqua, olio
Pressione di lavoro	130 bar (Ø4), 180 bar (Ø6), 150 bar (Ø8), 110 bar (Ø10) 75 bar (Ø12), 70 bar (Ø15)
Applicazioni	circuiti pneumatici
Tubi di collegamento consigliati	rame, ottone, acciaio, alluminio, plastici (con anima rinforzo)

### CARATTERISTICHE COSTRUTTIVE

Corpo	ottone nichelato
Dado	ottone nichelato
Guarnizione	NBR

HGO03 Diritto maschio conico

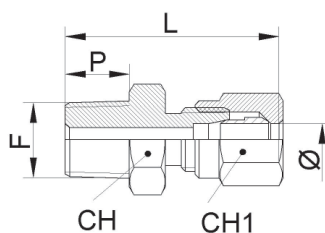

Codice	CH	CH1	F	L	P	Ø
HGO030418	12	10	R1/8	27,5	8	4
HGO030618	12	12	R1/8	27,5	8	6
HGO030818	12	14	R1/8	31	8	8
HGO030614	14	12	R1/4	31,5	11	6
HGO030814	14	14	R1/4	33	11	8
HGO031014	14	17	R1/4	33	11	10
HGO030838	17	14	R3/8	34	11	8
HGO031038	17	17	R3/8	33,5	11	10
HGO031238	17	19	R3/8	33,5	11	12
HGO031212	22	19	R1/2	36,5	14	12
HGO031512	22	24	R1/2	41	14	15

HGO04 Diritto maschio cilindrico

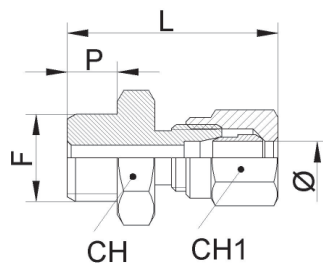

Codice	CH	CH1	F	L	P	Ø
HGO040418	14	10	G1/8	25,5	6	4
HGO040618	14	12	G1/8	25,5	6	6
HGO040818	14	14	G1/8	29	6	8
HGO040614	17	12	G1/4	28,5	8	6
HGO040814	17	14	G1/4	30	8	8
HGO041014	17	17	G1/4	30	8	10
HGO040838	19	14	G3/8	31	9	8
HGO041038	19	17	G3/8	31,5	9	10

HGO09 Gomito maschio conico

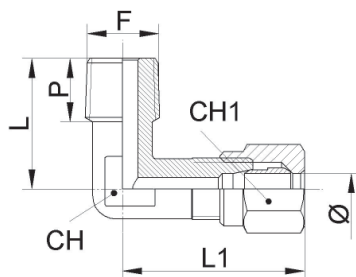

Codice	CH	CH1	F	L	L1	P	Ø
HGO090418	9	10	R1/8	18	24	8	4
HGO090618	9	13	R1/8	17	24,5	8,5	6
HGO090818	10	14	R1/8	18	25,5	8	8
HGO090614	10	12	R1/4	20	24	11	6
HGO090814	10	14	R1/4	21	29	11	8
HGO091014	14	17	R1/4	25	29,5	11	10
HGO090838	14	14	R3/8	26,5	32,5	11	8
HGO091038	14	17	R3/8	26,5	32,5	11	10
HGO091238	14	19	R3/8	26,5	33	11	12
HGO091212	17	19	R1/2	30	33	14	12
HGO091512	17	24	R1/2	30	37	14	15

HGO14 T laterale maschio conico

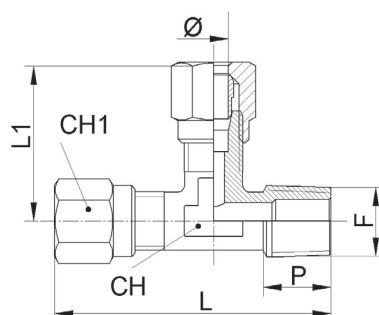

Codice	CH	CH1	F	L	L1	P	Ø
HGO140418	9	10	R1/8	38,5	22,5	8	4
HGO140618	9	12	R1/8	39,5	23,5	8	6
HGO140818	12	14	R1/8	46,5	26,5	8	8
HGO140614	10	12	R1/4	45	25	11	6
HGO140814	10	14	R1/4	47,5	28	11	8
HGO141014	12	17	R1/4	53	30	11	10
HGO141038	13	17	R3/8	60	34	11	10
HGO141238	13	19	R3/8	60	34	11	12
HGO141212	17	19	R1/2	64	36	14	12

5

HGO16 T centrale maschio conico

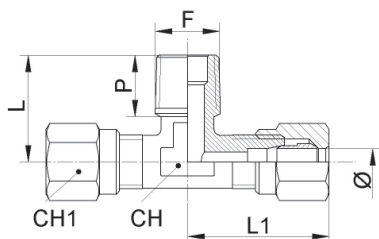

Codice	CH	CH1	F	L	L1	P	Ø
HGO160418	9	10	R1/8	16	21,5	8	4
HGO160618	9	12	R1/8	16	23	8	6
HGO160818	12	14	R1/8	20,5	26,5	8	8
HGO160614	10	12	R1/4	20	25	11	6
HGO160814	10	14	R1/4	20,5	27	11	8
HGO161014	12	17	R1/4	23	30	11	10
HGO161038	13	17	R3/8	26	34	11	10
HGO161238	13	19	R3/8	26	34	11	12
HGO161212	17	19	R1/2	28	36	14	12
HGO161512	17	24	R1/2	28	38	14	15

HGO19 Diritto intermedio

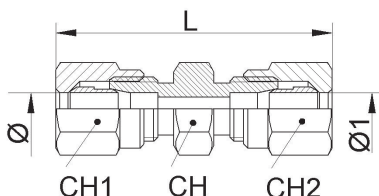

Codice	CH	CH1	CH2	L	Ø	Ø1
HGO190400	10	10	10	35	4	4
HGO190600	12	12	12	37	6	6
HGO190800	14	14	14	40	8	8
HGO191000	17	17	17	42	10	10
HGO191200	19	19	19	42	12	12
HGO191500	22	22	22	47	15	15

HGO20 Gomito intermedio

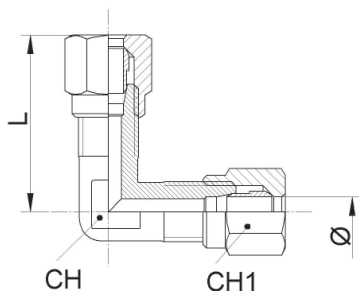

Codice	CH	CH1	L	Ø
HGO200400	9	10	27	4
HGO200600	9	13	24,5	6
HGO200800	10	14	28,5	8
HGO201000	14	17	32	10
HGO201200	13	19	35	12

HGO21 T intermedio

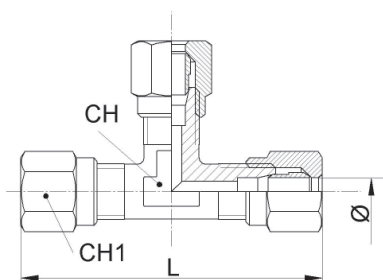
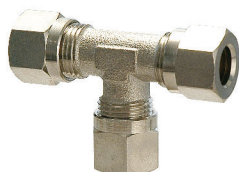

Codice	CH	CH1	L	Ø
HGO210400	9	10	42	4
HGO210600	9	12	46	6
HGO210800	12	14	54	8
HGO211000	12	17	60	10
HGO211200	13	19	68	12
HGO211500	17	24	74,5	15

HGO30 Dado

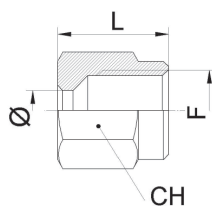

Codice	CH	F	L	Ø
HGO300400	10	M8x1	11	4
HGO300600	12	M10x1	12	6
HGO300800	14	M12x1	13	8
HGO301000	17	M14x1	13	10
HGO301200	19	M16x1	13	12
HGO301500	24	M20x1	15	15

HGO31 Ogiva

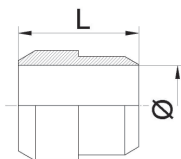

Codice	L	Ø
HGO310400	6	4
HGO310600	7,5	6
HGO310800	7	8
HGO311000	7	10
HGO311200	7	12
HGO311500	8	15

HGO32 Anima di rinforzo

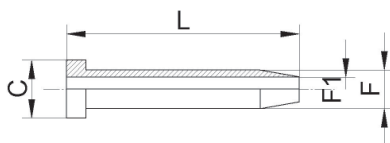

Codice	C	F	F1	L
HGO320600	5	4	3,3	12
HGO320800	7	6	5	15
HGO321000	9	8	7	15
HGO321200	11	10	9	15
HGO321500	14	12,5	11,5	17

HGO33 Passaparete

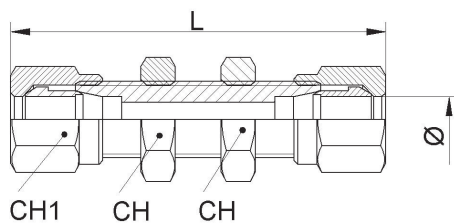

Codice	CH	CH1	L	Ø
HGO330600	14	12	48	6
HGO330800	17	14	53	8
HGO331000	19	19	62,5	10
HGO331200	22	22	64,5	12

HGO40 Anello singolo

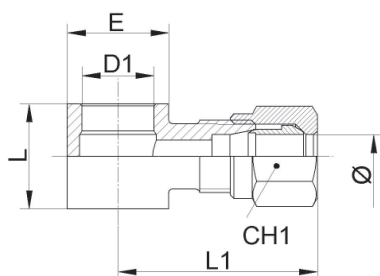

Codice	CH1	D1	E	L	L1	Ø
HGO400618	12	9,9	14	14,5	27	6
HGO400818	14	9,9	14	14,5	28	8
HGO400614	12	13,3	18	14,5	30	6
HGO400814	14	13,3	18	14,5	31	8

Asta da utilizzare: HD42 - HD43 - HD44

5