

DMS100

Power clamps conforming to the CNOMO Standard

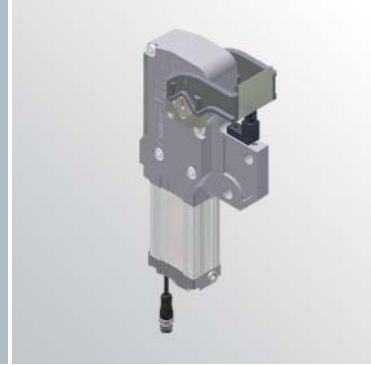

D	M	S	1	0	0	M	P	N	E	E	T	N
1		2			3		4	5	6			

1 Series	2 Size	3 Mechanism
DMS = power clamp conforming to the CNOMO Standard	100 = 100 Nm (size 50, cylinder Ø 40mm)	MP = pneumatic mechanism

4 Brake	5 Sensing style/Version	6 Clamping arm
N = without brake system V = with brake system	S = no sensor E = UNIVERSAL version, with three-wires electronic sensor and stepless adjustment of the opening angle from 25° to 105°	ETN = standard arm ETC = short arm

UNIVERSAL Power clamp conforming to the CNOMO standard

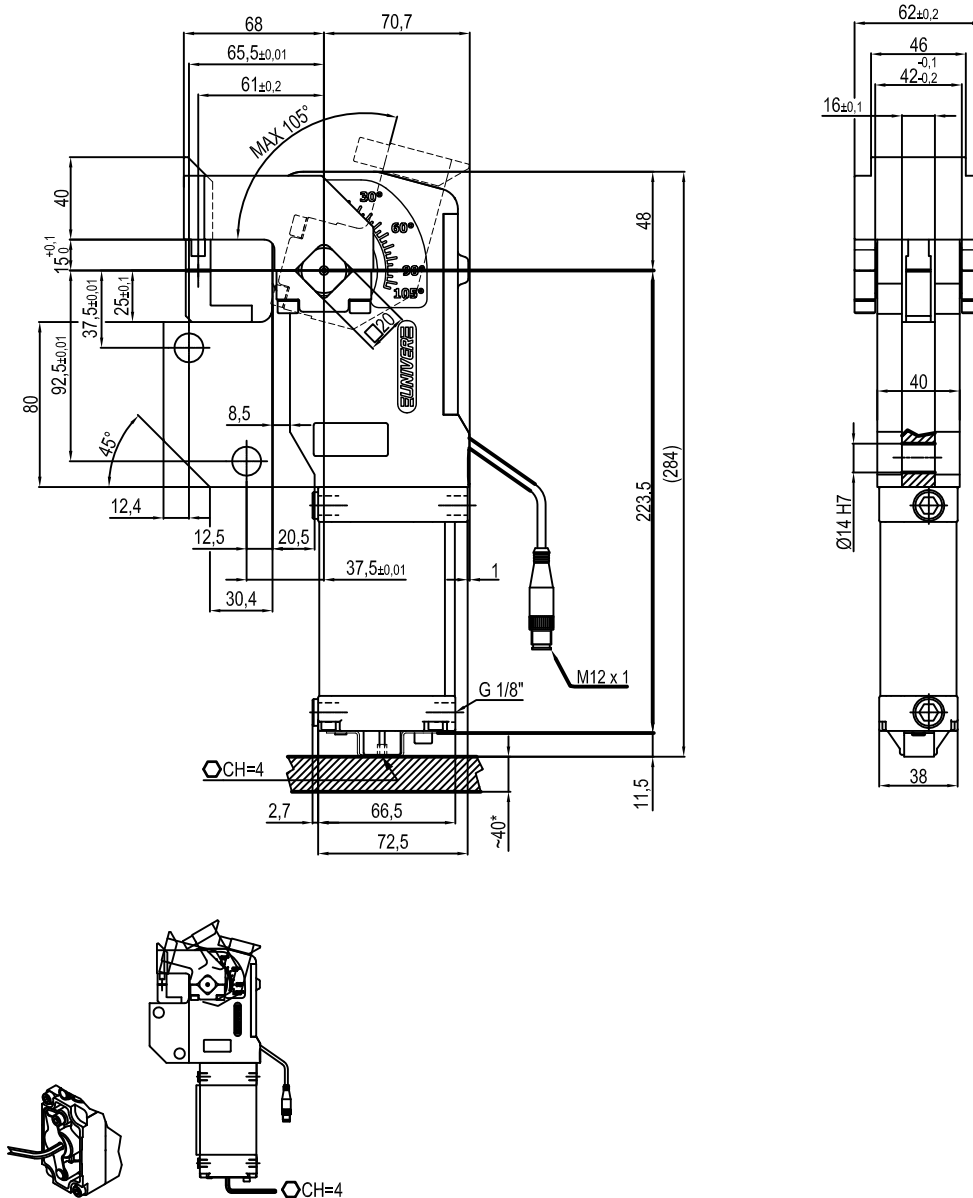

Size	Cylinder	Weight
100	40	2.4 Kg.

Min./Max. operating pressure: **0,4 / 0,8 MPa**
 Operating temperature: **5° + 45° C**
 Opening angle: **adjustable from 25° to 105°**
 Electronic sensor with M12
 Supply voltage: 10÷30 Vdc
 IP code: **IP 65**
 Pneumatic ports on both sides

* : AREA TO ACCES ANGLE ADJUSTMENT

Subject to technical modifications without notice

UNIVERSAL Power clamp conforming to the CNOMO standard

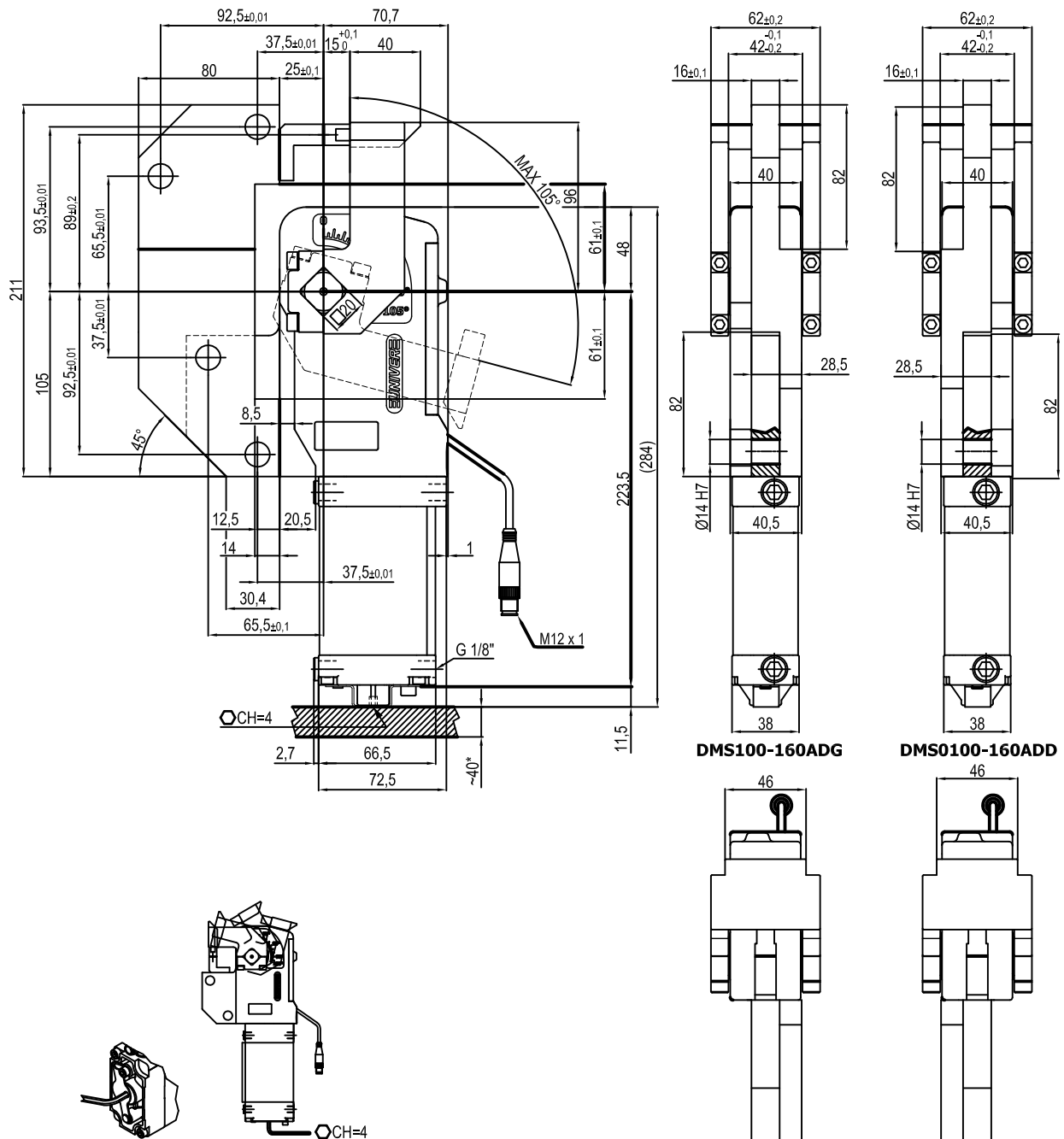

Size	Cylinder	Weight
100	40	3.2 Kg.

Min./Max. operating pressure: **0,4 / 0,8 MPa**
 Operating temperature: **5° + 45° C**
 Opening angle: **adjustable from 25° to 105°**
 Electronic sensor with M12
 Supply voltage: 10÷30 Vdc
 IP code: **IP 65**
 Pneumatic ports on both sides

* : AREA TO ACCES ANGLE ADJUSTMENT

Subject to technical modifications without notice