

# LCQ63

Pneumatic retractable locating pin unit with hand lever, single rod



L	C	Q	6	3	0	5	0	U	1	2	R
1	2	3	4		5	6		7			

<b>1 Series</b>	<b>2 Version</b>	<b>3 Size</b>
-----------------	------------------	---------------

LC = Retractable locating pin unit

Q = Pneumatic with hand lever, single rod

63 = Ø 63 mm

<b>4 Strokes</b>	<b>5 Sensor</b>	<b>6 Rod's inner Ø</b>
------------------	-----------------	------------------------

025 = 25 mm  
050 = 50 mm

U = Electronic sensor

12 = Ø 12 mm  
20 = Ø 20 mm

<b>7 Rod scraper</b>
----------------------

R = Metallic rod scraper

## Retractable locating pin unit

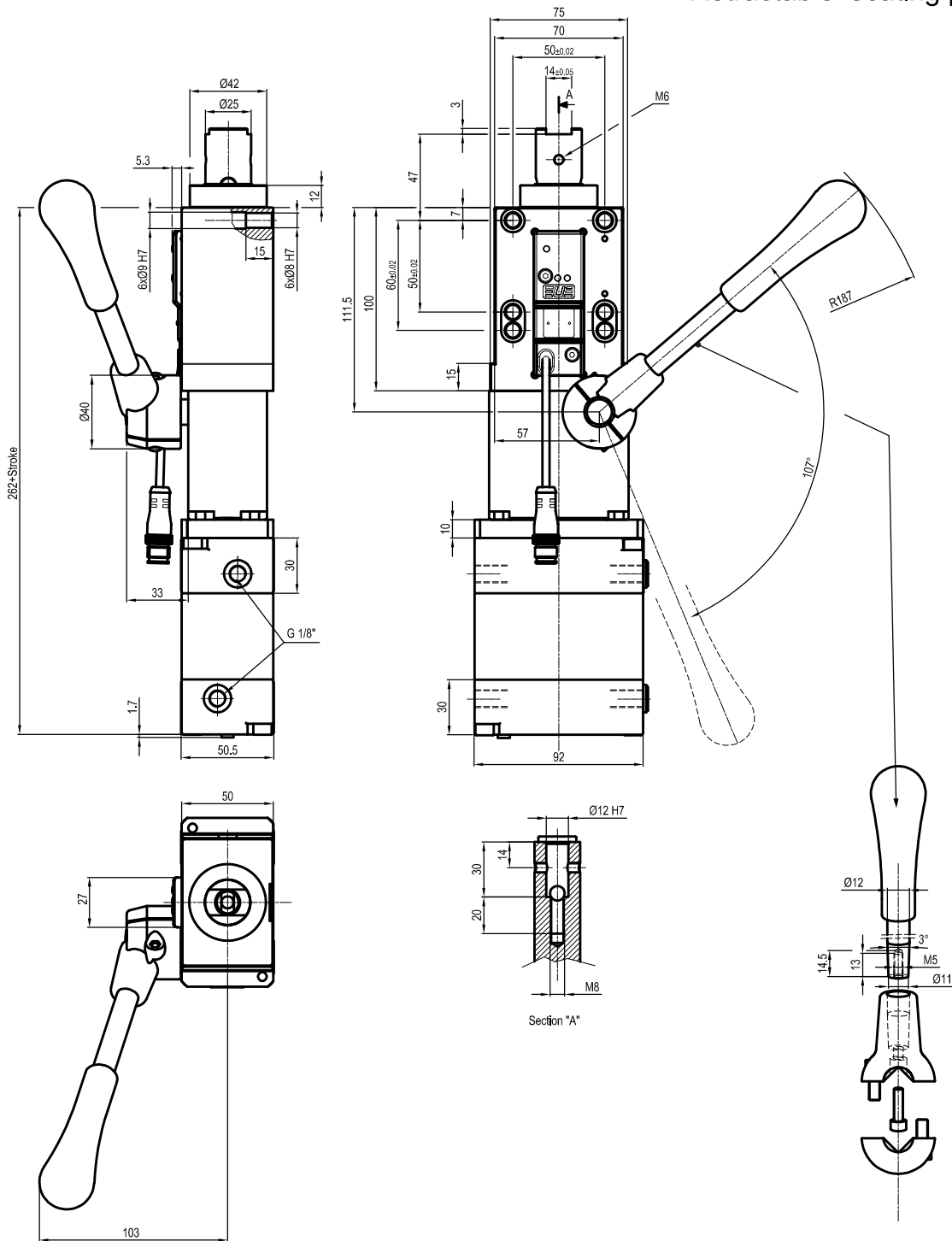

ROD'S INNER $\varnothing 12$	
CYLINDER $\varnothing$	WEIGHT
CYLINDER $\varnothing 50$	3,6 Kg

Min./max. operating pressure: **0,4 / 0,6 MPa**  
 Operating temperature: **5° ÷ 45° C**  
 Strokes in mm: 25-50  
 Electronic sensor with M12  
 Supply voltage: 10÷30 Vdc  
 IP code: **IP 65**  
 Pneumatic ports on both sides

## Retractable locating pin unit

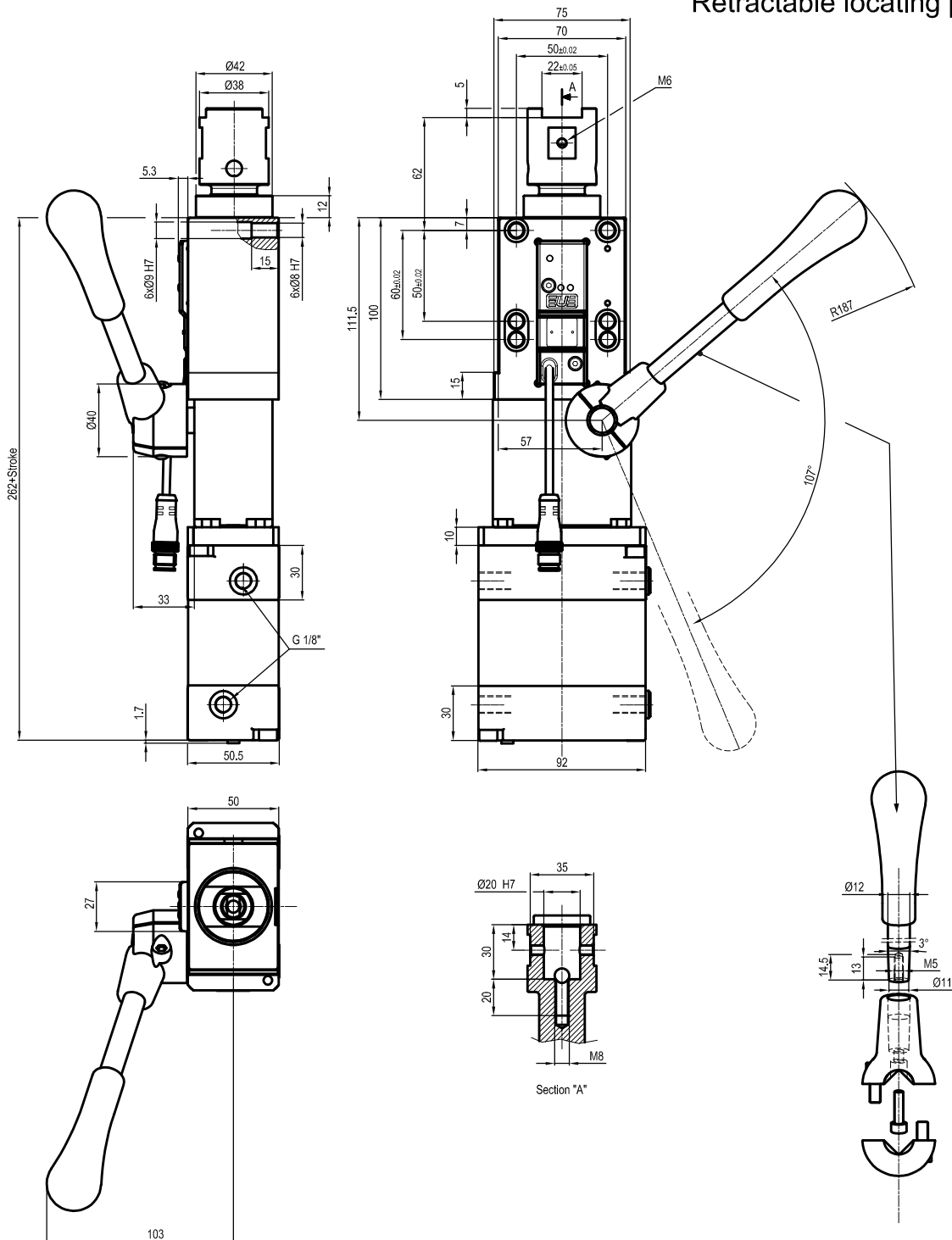

ROD'S INNER Ø20	
CYLINDER Ø	WEIGHT
CYLINDER Ø50	3,6 Kg

Min./max. operating pressure: **0,4 / 0,6 MPa**  
 Operating temperature: **5° ± 45° C**  
 Strokes in mm: 25-50  
 Electronic sensor with M12  
 Supply voltage: 10-30 Vdc  
 IP code: **IP 65**  
 Pneumatic ports on both sides