

- Miniature limit switches**
- Miniature limit switches, mounted on threaded bases or fitted with quick-connect fittings, can be paired with various manual control panel actuators, meeting a wide range of system requirements.

	<b>Fluid</b>	50 µm filtered air, with or without lubrication
	<b>Temperature ambient</b>	-10 ÷ +90°C
	<b>Temperature fluid</b>	max +50°C
	<b>Commutation system</b>	poppet
	<b>Ways/Position</b>	2/2 NC, 3/2 NC, 2/2 NO, 3/2 NO
	<b>Pressure</b>	max 10 bar
	<b>Control</b>	manual, mechanical
	<b>Return</b>	mechanical spring
	<b>Connections</b>	interface for sub-base
	<b>Nominal bore (mm)</b>	2,3 mm (1,5 sensible type)
	<b>Nominal flow rate (NL/min)</b>	110 NL/min (55 sensible type)
	<b>Valve body</b>	zamak
	<b>Seals</b>	NBR
	<b>Sub-base</b>	zamak
	<b>Spool</b>	nickel-plated brass

**Reference standard**

II 2G Ex h IIC T5 Gb

II 2D Ex h IIIC T100°C Db

**FLOW RATE CHARACTERISTICS**

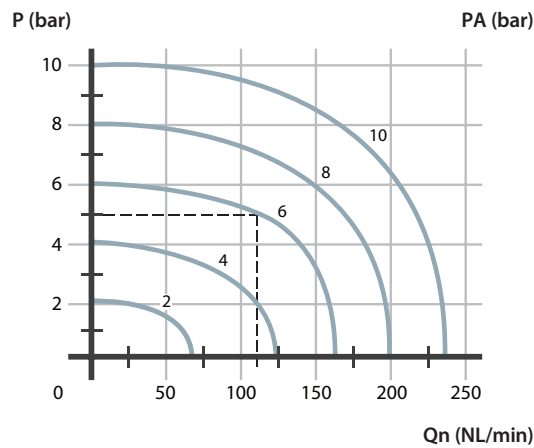

P (bar) = Working pressure  
 PA (bar) = Supply pressure  
 Qn (NL/min) = Flow rate

**MECHANICAL PUSH BUTTON - SPRING**

Code	Way	Return	Ø	Flow rate NI/min	Force N	Weight Kg	Note	
<b>AI-3500</b>	3/2 NC	mechanical spring	2,3	110	15	0,040	-	
<b>AI-3500S</b>	3/2 NC	mechanical spring	1,5	55	4	0,040	Sensible	
<b>AI-3501</b>	3/2 NO	mechanical spring	2,3	110	15	0,040	-	
<b>AI-3501S</b>	3/2 NO	mechanical spring	1,3	45	4	0,040	Sensible	
<b>AI-3502</b>	2/2 NC	mechanical spring	2,3	110	15	0,040	-	
<b>AI-3503</b>	2/2 NO	mechanical spring	2,3	110	15	0,040	On request	

**PNEUMATIC AND MECHANICAL ACTUATORS**

	<b>AI-3550</b>	Pneumatic operator	
	<b>AI-3551</b>	Amplified pneumatic operator	
	<b>AI-3560</b>	Roller operator 1 position	
	<b>AI-3562</b>	Ball-push operator 1 position	
	<b>AI-3563</b>	Operator with omni-directional antenna 1 position	
	<b>AI-3570</b>	Roller lever operator 1 position	
	<b>AI-3571</b>	Articulated roller operator 1 position Complete actuation with stroke 2,5 mm, max stroke 4,7 mm	
	<b>AI-3572</b>	Key operator 1 position	

**MANUAL ACTUATORS**

	<b>AI-3511</b>	■ BLACK	
	<b>AI-3512</b>	■ RED	Recessed button
	<b>AI-3513</b>	■ GREEN	
	<b>AI-3514</b>	■ RED	Head button
	<b>AI-3516</b>	■ BLACK	
	<b>AI-3514D</b>	■ RED	
	<b>AI-3516D</b>	■ BLACK	
	<b>AI-3515</b>	■ GREEN	Button
	<b>AI-3517</b>	■ RED	
	<b>AI-3519</b>	■ BLACK	
	<b>AI-3520</b>	■ BLACK	Accident prevention rotating selector
	<b>AI-3521</b>	■ BLACK	
	<b>AI-3522</b>	■ BLACK	Rotating lever selector
	<b>AI-3523</b>	■ BLACK	
	<b>AI-3524</b>	■ BLACK	Lever operator
	<b>AI-3525</b>	■ BLACK	Omni - directional operator
	<b>AI-3526</b>	■ BLACK	Push-pull operator

**MECHANICAL PUSH BUTTON FOR PANEL MOUNTING - SPRING**

Code	Way	Return	Ø	Flow rate NI/min	Force N	Weight Kg	Note	
<b>AI-3500Q</b>	3/2 NC	mechanical spring	2,3	110	15	0,055	-	
<b>AI-3500SQ</b>	3/2 NC	mechanical spring	1,5	55	4	0,055	Sensibile	
<b>AI-3501Q</b>	3/2 NO	mechanical spring	2,3	110	15	0,055	-	
<b>AI-3501SQ</b>	3/2 NO	mechanical spring	1,3	45	4	0,055	Sensibile	
<b>AI-3502Q</b>	2/2 NC	mechanical spring	2,3	110	15	0,055	-	
<b>AI-3503Q</b>	2/2 NO	mechanical spring	2,3	110	15	0,055	A richiesta	

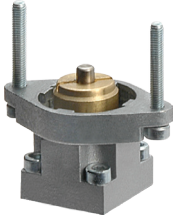

**MANUAL ACTUATORS**

	<b>AI-3511Q</b>	■ BLACK	Recessed button	
	<b>AI-3512Q</b>	■ RED		
	<b>AI-3513Q</b>	■ GREEN		
	<b>AI-3514Q</b>	■ RED	Head button	
	<b>AI-3516Q</b>	■ BLACK		
	<b>AI-3514QD</b>	■ RED		
	<b>AI-3516QD</b>	■ BLACK		
	<b>AI-3515Q</b>	■ GREEN	Button	
	<b>AI-3517Q</b>	■ RED		
	<b>AI-3519Q</b>	■ BLACK		
	<b>AI-3520Q</b>	■ BLACK	Accident prevention rotating selector	
	<b>AI-3521Q</b>	■ BLACK		
	<b>AI-3522Q</b>	■ BLACK	Rotating lever selector	
	<b>AI-3523Q</b>	■ BLACK		
	<b>AI-3524Q</b>	■ BLACK	Lever operator	
	<b>AI-3525Q</b>	■ BLACK	Omni - directional operator	
	<b>AI-3526Q</b>	■ BLACK	Push-pull operator	

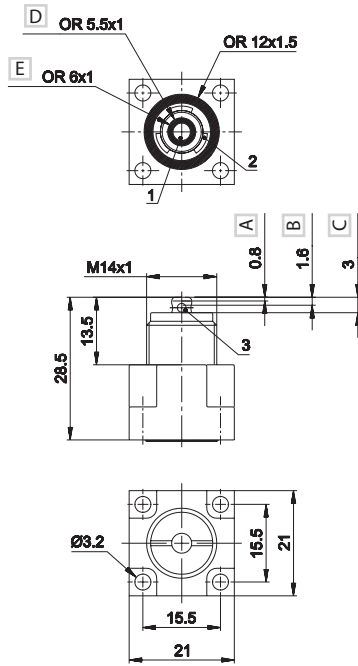
MECHANICAL PUSH BUTTON - SPRING

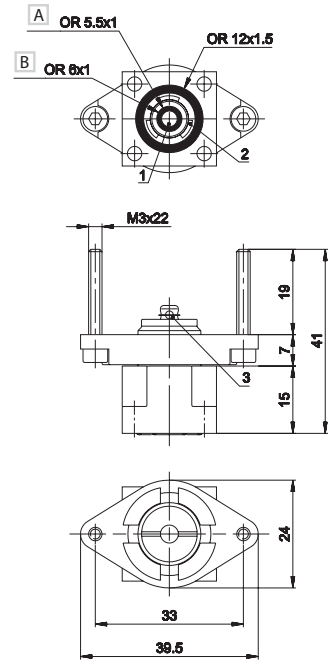

MECHANICAL PUSH BUTTON FOR PANEL MOUNTING - SPRING



- 1 Supply port
- 2 Use
- 3 Exhaust
- A Pre-stroke
- B Max opening
- C Total stroke
- D 3/2 NC-3/2 NO-2/2 NC
- E 2/2 NO

- 1 Supply port
- 2 Use
- 3 Exhaust
- A 3/2 NC-3/2 NO-2/2 NC
- B 2/2 NO

SUB-BASE WITH BOTTOM CONNECTIONS M5

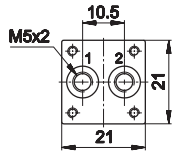
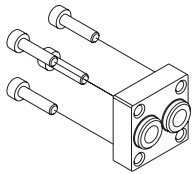

AI-3610

Sub-bases are supplied with M3x12 fixing screws (4 pcs) and M5x5 grub screws (2pcs) to close the unused ways.

AI-3610 + AI-3500

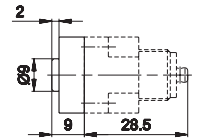
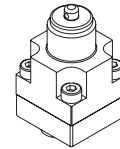

AI-3610 + AI-3500Q

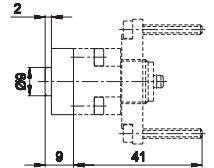
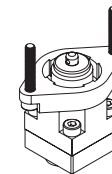

SUB-BASE WITH SIDE OR BOTTOM CONNECTIONS M5

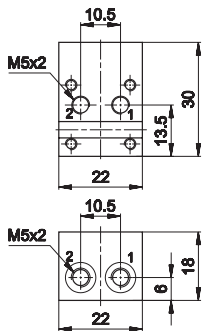
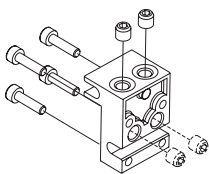

AI-3612

Grub screws must be fixed with sealing loctite (243 type), being sure that loctite does not obstruct the ports or sink inside the valve.

Grub screws must be screwed until reaching the base surface. Avoid screwing them completely.

AI-3612 + AI-3500

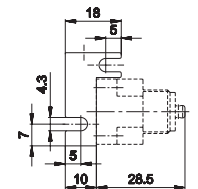
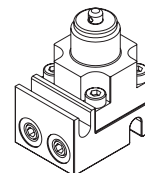

AI-3612 + AI-3500Q

